

IMPORTANT: Please read and save these instructions. Read through this owner's manual carefully before using product. Protect yourself and others by observing all safety information, warnings and cautions. Failure to comply with instructions could result in personal injury and/or damage to product or property. Please retain instructions for future reference.

SICKLE-BAR MOWER

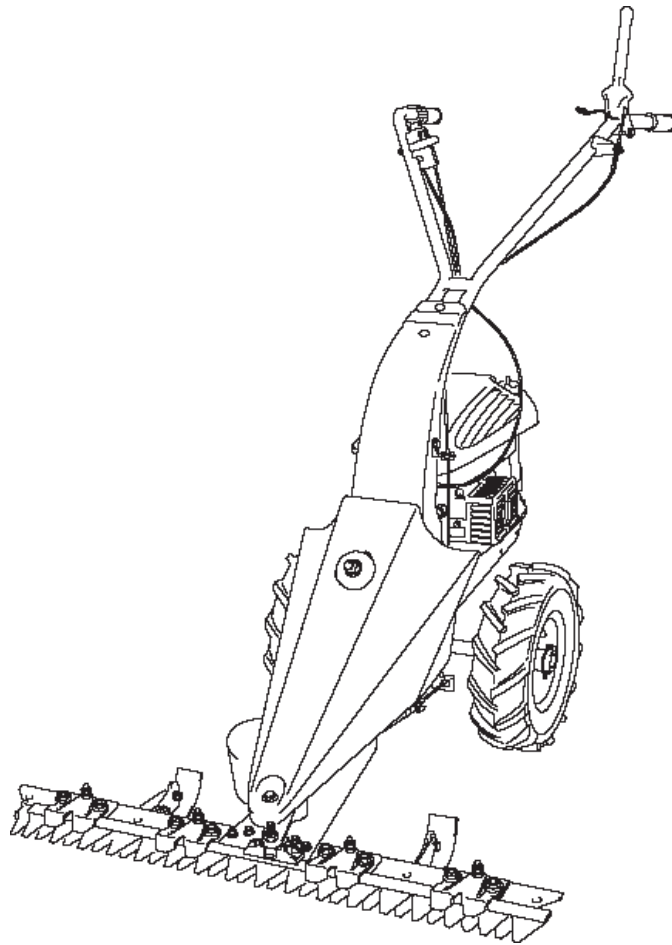

Due to continuing improvements, actual product may differ slightly from the product described herein.

OPERATING INSTRUCTIONS



Dear Customer,

Congratulations on your purchase!

Your new product has been developed and manufactured to state-of-the-art technology.

Before using the product for the first time, please be sure to read these instructions for use! They provide you with all information necessary for using the product safely and to ensure its long service life. Closely observe all safety information in these instructions!

Getting started...

Proper use

The product is intended for cutting grass areas in private and hobby gardens.

The product may not be used for commercial purposes.

The product may not be used in potentially explosive environments.

The product may not be used in environments in which a fire hazard exists.





The product must be operated according to the manufacturer's specifications in the instructions for use.

Any improper use or any activities on the product not described in these instructions for use are considered inadmissible misuse and outside of the manufacturer's legal liability.

What do the symbols mean?

In the instructions for use

Danger and information signs are clearly marked in the instructions for use. The following symbols are used:

<hr/>	
	DANGER Type and source of danger! Failure to observe the danger sign can put life and limb at risk.
<hr/>	
	WARNING Type and source of danger! Failure to observe the danger sign can put life and limb at risk.
<hr/>	
	CAUTION Type and source of danger! This danger sign warns against damage to the product, environment or other property.
<hr/>	
	Note: This symbol identifies information that is provided to improve understanding of the processes.
<hr/>	

For your safety

General safety instructions

- WARNING -Reduce the risk of injury by reading the instructions for use.
- WARNING! Read all safety information and instructions! Failure to observe the safety information and instructions can cause electric shock, fire and/or serious injury.
- Should you pass the product on, ensure that it is accompanied by the instructions for use. Keep all instructions for use and safety instructions for future reference.
- Observe all safety instructions! If you do not observe the safety instructions you will endanger yourself and others.
- Keep the work area clean and well-illuminated. Untidiness and unlit working areas can lead to accidents.
- Wear personal protective equipment and always use safety goggles. Wearing personal pro-

protective equipment such as hearing protection reduces the risk of injury.

- Keep children and other persons away when using the product. Distractions may cause you to lose control of the product.
- All parts of the product must be correctly installed to ensure faultless operation.
- Young people under 16 years of age and users who are not sufficiently acquainted with its operation must not use the product.
- The product may be used only when in a faultless condition. If the product or a part of it is defective, it must be repaired by Dealer's Service.
- The surroundings must be free of highly-flammable or explosive materials.
- Do not operate the product unless the protection devices are fitted.
- take care at the cutting tool – maintain an adequate safe distance.
- Exercise caution with tools that run-on. Before commencing work on these tools, wait until they have come to a complete standstill!
- Danger of poisoning due to exhaust fumes! Do not start the motor or use the product in enclosed spaces.
- Never leave the product unattended with the motor running.
- Check the fuel system for leaks or defective parts on a regular basis.
- Always switch off the motor when transporting or refuelling.
- Carefully remove overflowing fuel without delay.
- Conversions, unauthorized modifications and the use of non-approved parts are prohibited.
- Always heed the applicable national and international safety, health and labour regulations.
- Work with caution and only if you are physically fit: Working under the effects of fatigue, illness, alcohol, medication and drugs is irresponsible.
- Only the maintenance work and trouble shooting activities described here may be carried out. All other work must be carried out by Dealer's Service.
- Use only genuine spare parts. Only these spare parts are designed and suitable for the product. The use of other spare parts not only invalidates the warranty, it also presents a danger to yourself and your environment.

Raynaud's syndrome (white-finger syndrome)

The frequent use of vibrating devices can damage the nerves of persons whose blood flow is impaired (e.g. smokers, diabetics). Fingers, hands, wrists and/or arms in particular show some or all of the following symptoms: Pain, prickling, twinges, deadening of limbs, pale skin.

If you notice anything unusual, stop working immediately and consult a physician.

You can substantially reduce the risks if you adhere to the following instructions:

- Keep your body and particularly your hands warm in cold weather. Working with cold hands is the main cause!
- Take regular breaks and move your hands. This encourages circulation.
- Ensure that the product vibrates as little as possible through regular maintenance and tight parts on the product.

Product-specific safety information

CAUTION

Product damage!

The product is supplied without motor oil.

Make sure it is filled with motor oil before using for the first time.

The oil level must be checked and topped up/refilled each time before using the motor.

Operating the motor with insufficient oil will damage the motor.

Dirty oil or two-stroke motor oil reduces the service life of the motor.

The motor oil must be changed after the first five operating hours.

Use the specified motor oil.





CAUTION

Product damage!

The product is supplied without gearbox oil.

Make sure it is filled with gearbox oil before using for the first time.
Operating the gearbox with insufficient oil will damage the gearbox.
Contaminated gearbox oil will reduce the service life of the gearbox.
Use the specified gearbox oil.

General instructions

- Carefully read the instructions for use. Familiarise yourself with the operating elements and the correct use of the product.
- Never allow children or other persons not acquainted with the operating instructions to use the product. Local regulations may specify the minimum age of the user.
- Never work when persons, especially children and animals, are close by.
- Remember that the operator or the user is responsible for accidents involving other persons or damage to their property.

Preparatory actions

- Always work wearing sturdy shoes and long trousers. Do not operate the product barefoot or wearing light shoes.
- Make a thorough check of the terrain on which the product is to be used and remove any objects that could be flung out by the product.
- Replace damaged exhaust silencers.
- Always visually examine the cutting tool before use to make sure it is not worn or damaged.

For handling fuels

- **WARNING** - Petrol is highly inflammable:
 - Only store petrol in containers fit for the purpose.
 - Only refuel outdoors and do not smoke during the refuelling process.
 - Petrol must be topped up before the motor is started.
 - Do not open the petrol cap or refill with petrol while the motor is running or the motor is hot.
 - Never attempt to start the motor if petrol has been spilt.
 - Instead, move the product away from the contaminated area. Avoid all attempts to start the motor until the petrol vapours have evaporated.
 - For safety reasons the petrol tank and petrol cap are to be replaced on a regular basis.

If used improperly, operating media (including fuels) endanger the environment:

- Take care when filling with operating media. Operating media must not run into the soil or into the sewer system.
- Operating media residues must be disposed of properly. Never dispose of them with household waste.
- Observe the applicable national regulations for the handling of the respective operating media.
- Fuels have a limited shelf-life. Buy only the quantity of fuel you will use up within the next few months.

Handling

- Do not run the motor in enclosed spaces in which dangerous carbon monoxide can collect.
- Only work in daylight or with adequate lighting.
- Always ensure good stability on slopes.
- Only operate the product at walking pace.
- Products on wheels: Always work across slopes, never up or down the slope.
- Be especially vigilant when changing direction on slopes.
- Never work on extremely steep slopes.
- Be particularly vigilant when turning the product round or pulling it towards you.

- Do not modify the motor's basic settings and do not over-rev it.
- Carefully start the motor in accordance with the instructions and ensure there is an adequate distance from your feet to the tool(s).
- Never place your hands or feet on or under rotating parts.
- Always keep your hands and feet well away from the area of the cutting tool.
- Never lift or carry a product while the motor is running.
- The motor must be switched off:
 - whenever you leave the product.
 - before refuelling.
- The throttle valve must be closed when the motor runs on. If the product is fitted with a petrol valve, this must be closed when work is complete.

Maintenance and storage

- Always make sure that all nuts, bolts and screws are firmly tightened. This will ensure that the product is in a safe working condition.
- While petrol is in the tank, never store the product in a building in which petrol vapours may come into contact with naked flames or sparks or can be easily ignited.
- Allow the motor to cool down before storing product in enclosed spaces.
- To avoid the risk of fire keep the motor and exhaust away from vegetable matter and leaking grease (oil).
- For safety reasons always replace worn or damaged parts.
- Should the tank need draining, do this outdoors.

Personal protective equipment



Wear appropriate hearing protection while working with the product! Wearing hearing protection reduces the risk of injury.



Wear safety shoes while you are working with the product! Wearing safety shoes reduces the risk of injury.



Wear tight fitting clothing while working with the product. Loose fitting clothing can get pulled in while working with the product.



Wear goggles while working with the product! Wearing goggles reduces the risk of injury.



Wear safety gloves while working with the product! Wearing safety gloves reduces the risk of injury.

Your product at a glance

1. Coupling handle (for cutting tool)
2. Latch
3. Steering
4. Arm housing
5. Motor oil filling screw
6. Exhaust with protective grille
7. Wheel
8. Ground sliders
9. Cutting tool
- 9.a Cutting tool guard
10. Air filter unit
11. Fuel pump (if the engine is with chock, it is without fuel pump)
12. Tank cover (for fuel)
13. Pull-starter
14. Throttle
15. Coupling handle (for wheel drive)

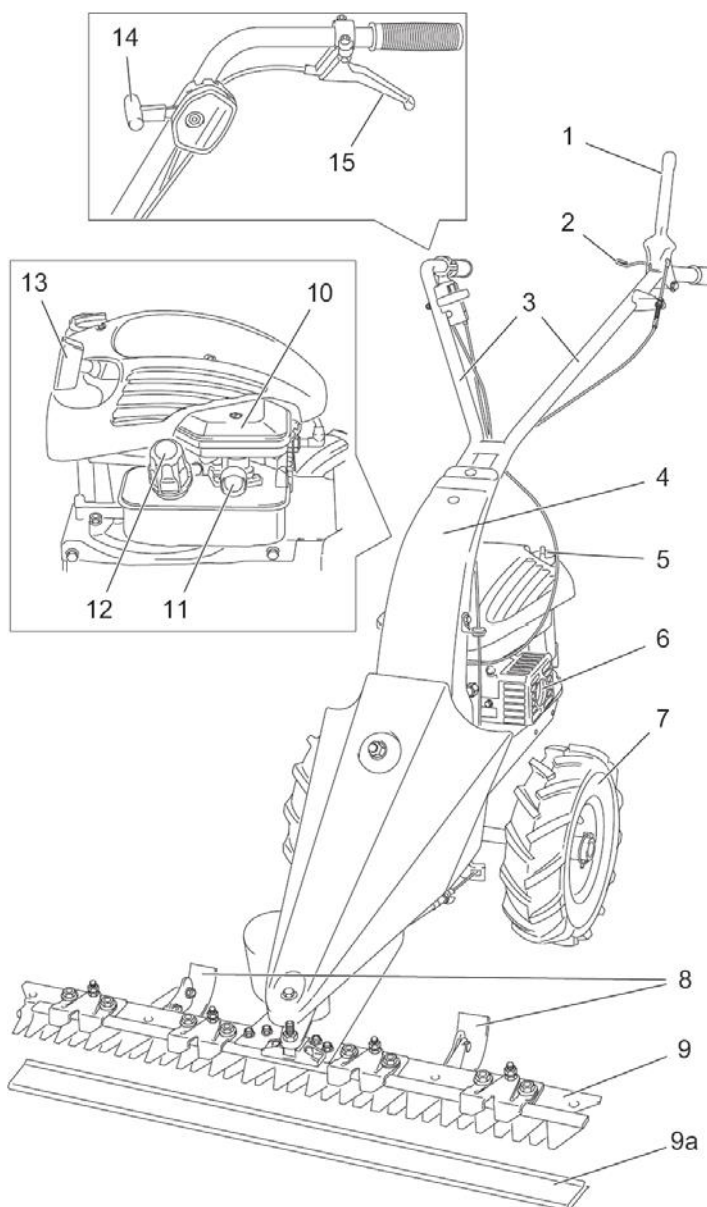

Supplied as standard

- Field mower
- Instructions for use
- Steering
- Arm housing
- Wheel (2 x)
- Cutting tool
- Sliding block
- Cutting tool guard
- Linch pin (2 x)



Note:

If a part is missing or damaged, please contact the vendor.

Assembly

Mounting the wheels



WARNING

Risk of injury!

Make sure that the linch pin closes fully.



CAUTION

Product damage!

Pay attention to the running direction of the wheel.

The profile of the wheels must point forward in travel direction.



CAUTION

Product damage!

Always make sure that the tyres have the correct air pressure.

- Push the protective cap (17) onto the drive shaft (16).
- Push the wheel (7) with the valve facing outwards onto the drive shaft (16). If necessary, first remove the linch pin (18) from the drive shaft (16).
- Push the linch pin (18) through the holes in the rim of the wheel (7) and the drive shaft (16).
- Close the linch pin (18).
- Repeat the procedure on the other side.

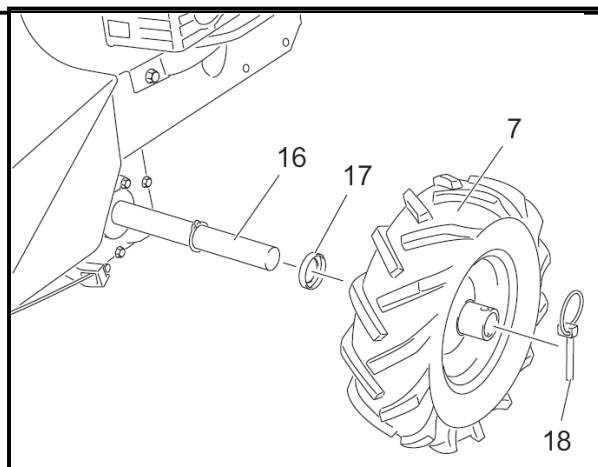

Mounting the arm housing

- Unscrew the screws (19) with the circlip and the washer on both sides of the product.
- Place the arm housing (4) onto the product and screw down to the product again with the screws (19).

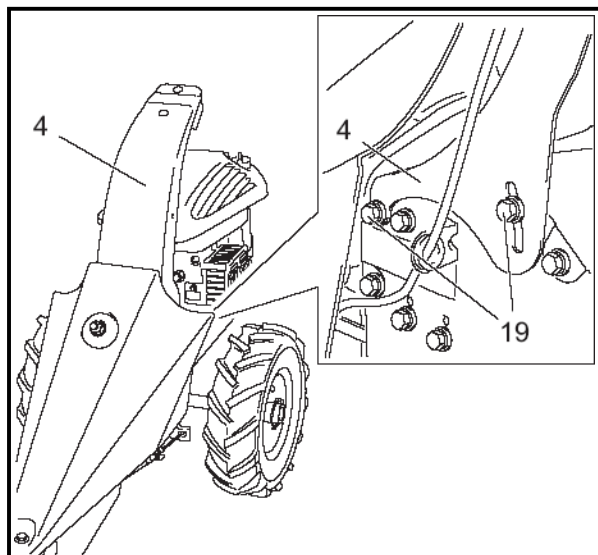

Mounting the steering



CAUTION Product damage!

Pay attention to the routing of the Bowden cables.
The Bowden cables may neither be routed in too small a radius nor may they be crushed.

- Loosen the self-locking nut (20) with the circlip and the washer from the round-head screw with square neck (21).
- Push the steering (3) onto the round-head screw with square neck (21).
- Screw the self-locking nut (20) with the circlip and the washer onto the round-head screw with square neck (21) and tighten it.

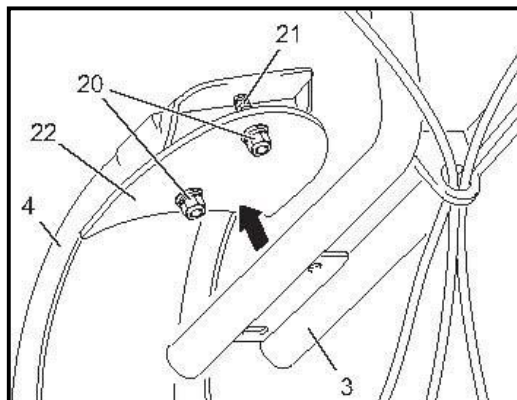

Note:

Make sure that the vibration damper (22) between the arm housing (4) and the steering (3) is installed.

Mounting the Bowden cable guide



CAUTION Product damage!

Pay attention to the routing of the Bowden cables.
The Bowden cables may neither be routed in too small a radius nor may they be crushed.

- Loosen the self-locking nut (28) with the circlip and the washer from the screw (29).
- Push the screw (29) with the washer through the hole in the bracket (30) and the arm housing (4).
- Screw the self-locking nut (28) with the circlip and the washer onto the screw (29) and tighten it.

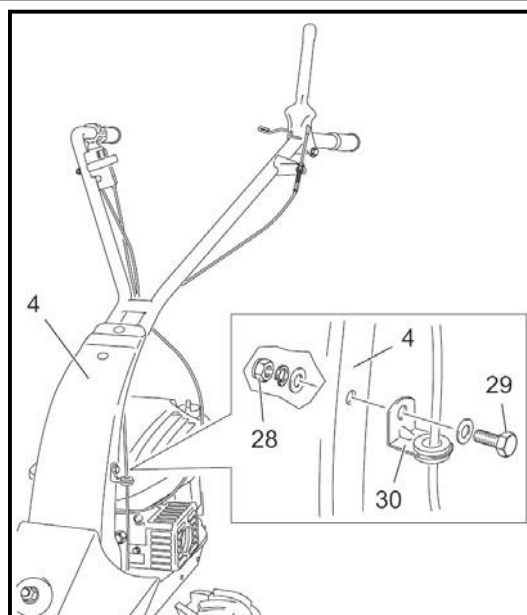

Mounting the cutter



WARNING

Risk of injury!

Make sure that the cutting tool guard (9a) is installed on the cutter (9).

- Loosen the self-locking nut (23) with the circlip and the washer from the screw (24) with the washer.
- Place the base plate (25) onto the cutter (9).
- Direct the sliding block (26) into the guide (27) on the cutter (9).
- Align the cutter (9) and the base plate (25) to one another.
- Direct the screw (24) with the washer from below through the cutter (9) and the base plate (25).
- Screw the self-locking nut (23) with the circlip and the washer onto the screw (24) and tighten it.

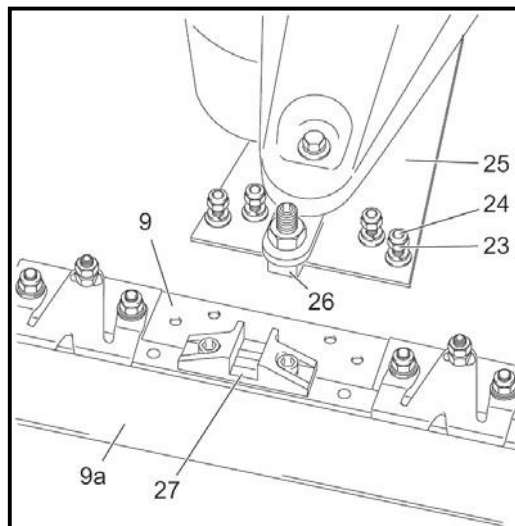

Using for the first time

Product controls



WARNING

Risk of injury!

Before performing any adjustment work, always switch the product off and remove the spark plug connector.

Setting the steering height

- Slightly loosen the screws (19) with the circlip and the washer on both sides of the arm housing (4).
- Set the desired steering height.
- Tighten the screws (19) with the circlip and washer again.

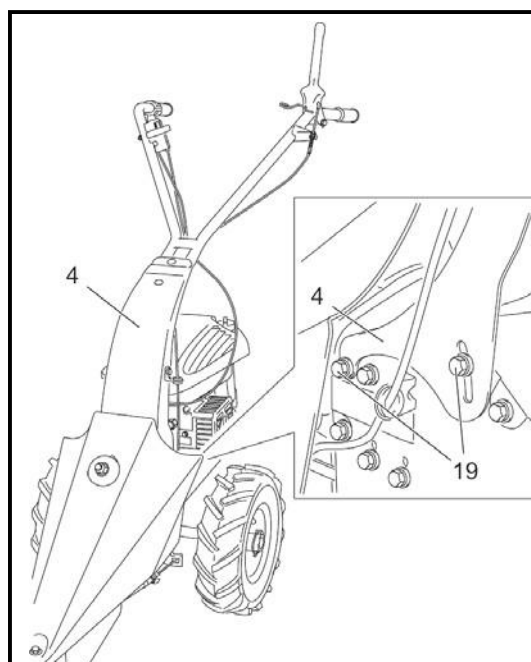

Adjust the sliding block



WARNING

Risk of injury!

Make sure that the cutting tool guard (9a) is installed on the cutter (9).



CAUTION

Product damage!

The sliding block (26) must always be correctly adjusted. An incorrect adjustment can result in the cutter jumping out of the guide (27) or damage being caused to the cutting tool (9).

- Secure the adjustment screw (31) against turning with a suitable tool.
- Loosen the nut (32) with a suitable tool.
- Change the height of the adjustment screw (31) by turning.
- Protect the adjustment screw (31) against turning with a suitable tool and tighten the nut (32) again using an appropriate tool.

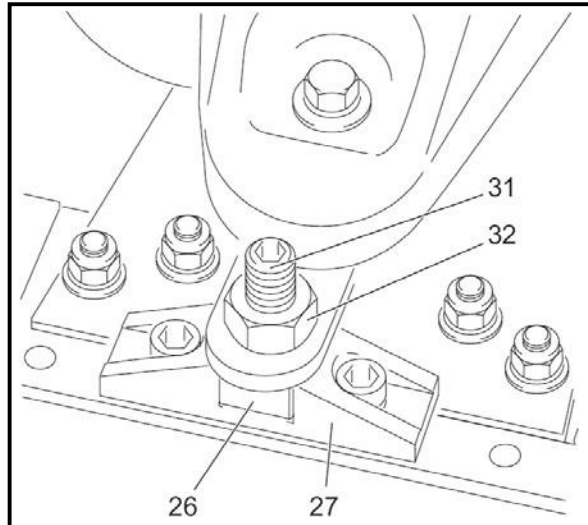

Adjusting the cutting height



WARNING

Risk of injury!



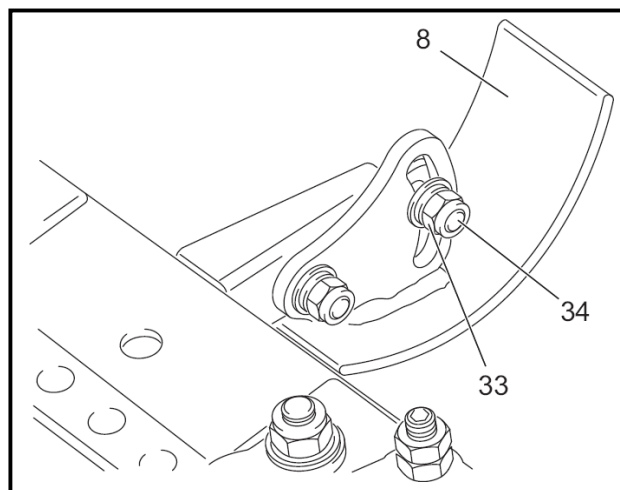

Never set the cutting height too low. The ground sliders (8) must still touch the ground.

The cutter (9) could become caught in the ground and cause the product to suddenly come to a halt.

- Slightly loosen the self-locking nut (33) with the circlip and the washer from the screw (34).
- Adjust the height of the ground sliders (8).
- Re-tighten the self-locking nut (33) with the washer and the screw (34).



Throttle

- Throttle in (14) position  = Motor off
- Throttle in (14) position  = minimum motor speed
- Throttle in (14) position  = maximum motor speed
- Throttle in (14) position  = Choke

Note: if the engine is with fuel pump, it is without choke.

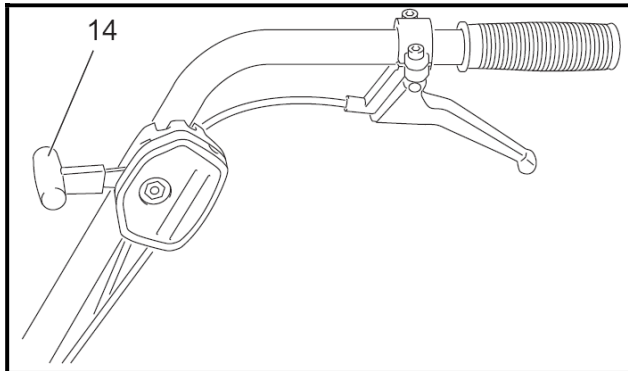

Coupling handle for wheel drive

When the coupling handle is released (15), the cable pull must be completely relieved.

- Coupling handle released (15) = product standstill
- Coupling handle (15) pulled = Wheels (7) begin to move and the product starts running.

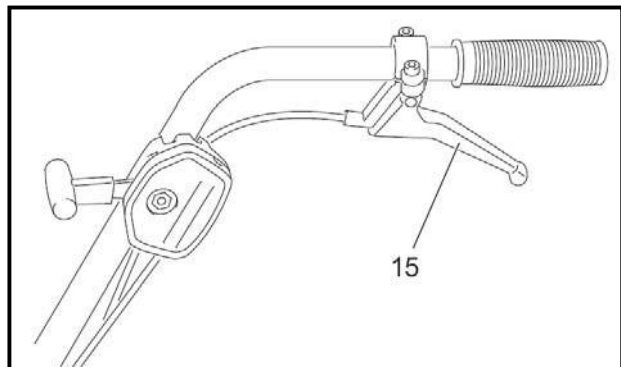

Coupling handle for cutting tool

When the coupling handle (1) is released, the cutting tool (9) must not move; When the coupling handle is pressed, the cutting tool (9) must start to move. The coupling handle (1) can be locked using the latch (2).

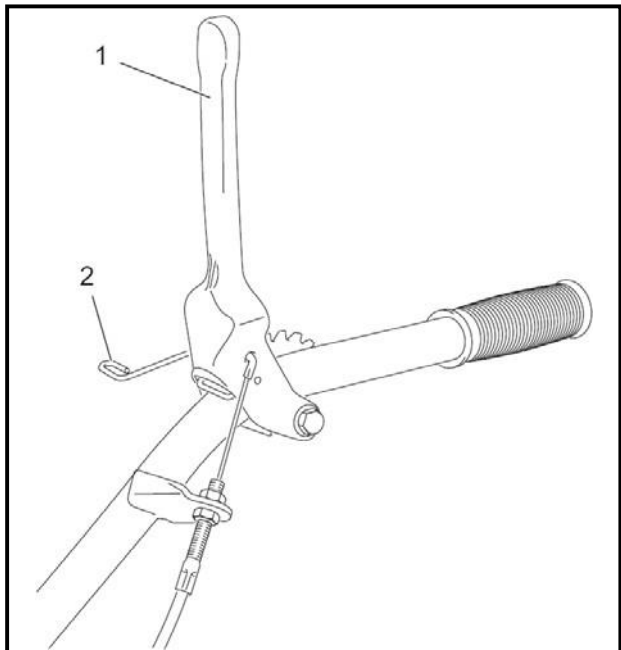

Filling with fuel



DANGER Risk of injury!

- Petrol is highly inflammable!
- Before refuelling, switch off the motor and let it cool down.
 - Closely observe all safety information for handling fuel.



Note:
Use only appropriate fuel.

- Switch off the motor.
- Disconnect the spark plug.
- Open and remove the tank cover (12).
- Carefully top up the fuel. Do not spill!
- Check the seal in the tank cover for damage and clean if necessary. Replace a damaged seal immediately!
- Re-tighten the tank cover (12) by hand.

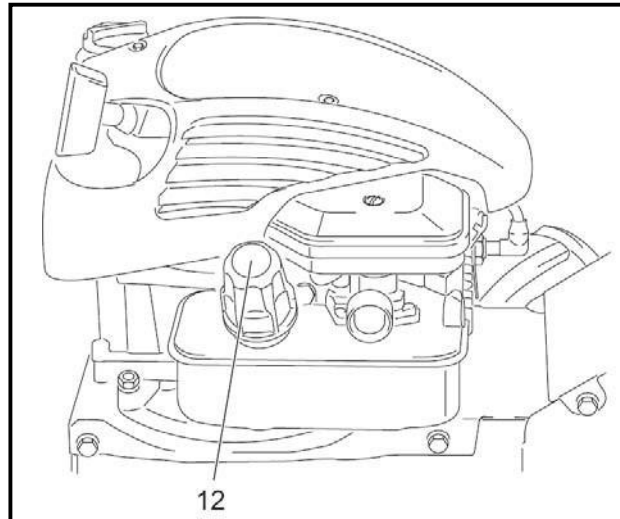

Filling with motor oil



CAUTION Product damage!

The product is supplied without motor oil.

- Make sure it is filled with motor oil before using for the first time.
The motor oil must be changed after the first five operating hours.
The oil level must be checked and topped up refilled each time before using the motor.

- Switch off the motor.
- Disconnect the spark plug.
- Unscrew and remove the motor oil filling plug (5).
- Carefully top up the motor oil. Do not spill!
- Check the seal in the motor oil filling plug (5) for damage and clean if necessary. Replace a damaged seal immediately!
- Re-tighten the motor oil filling plug (5) by hand.
- Check motor oil level.

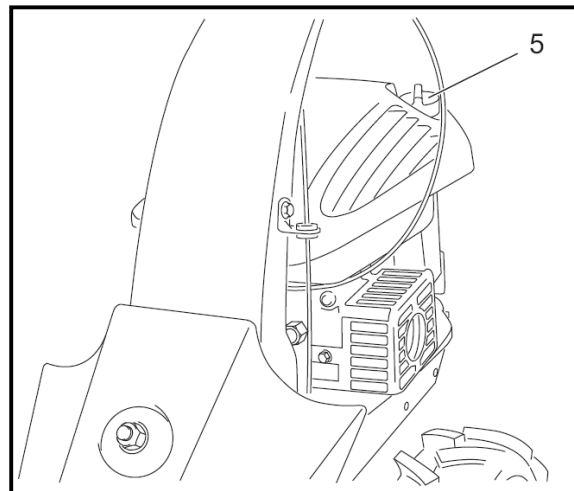

Filling with gearbox oil

CAUTION

Product damage!

The product is supplied without gearbox oil.



Make sure it is filled with gearbox oil before using for the first time. Operating the gearbox with insufficient oil will damage the gearbox. Contaminated gearbox oil will reduce the service life of the gearbox. Use the specified gearbox oil.

-
- Switch off the motor.
 - Disconnect the spark plug.
 - Unscrew and remove the gearbox oil filling plug (36) using a suitable tool.
 - Carefully top up the gearbox oil. Do not spill!
 - Re-tighten the gearbox oil filling plug (36).

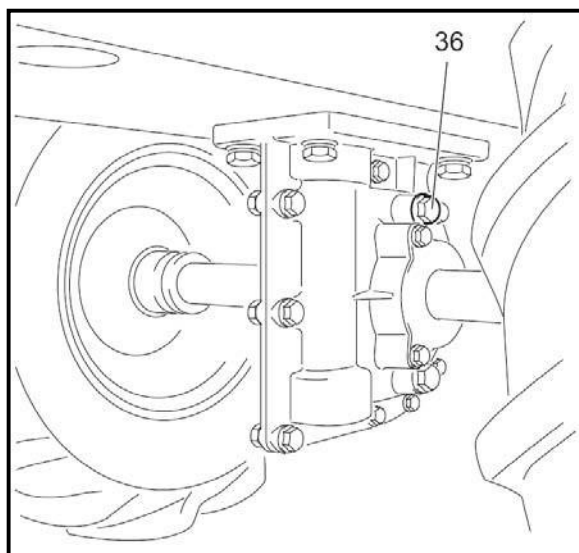

Operation

Check before starting!

WARNING

Risk of injury!

The product must only be put into operation if no defects are found. Ensure that any defective parts are replaced before the product is used again.



CAUTION

Product damage!

The product is supplied without motor oil.

Make sure it is filled with motor oil before using for the first time.

The oil level must be checked and topped up/refilled each time before using the motor.

Operating the motor with insufficient oil will damage the motor.

Dirty oil or two-stroke motor oil reduces the service life of the motor.

The motor oil must be changed after the first five operating hours.

Use the specified motor oil.



CAUTION

Product damage!

The product is supplied without gearbox oil.

Make sure it is filled with gearbox oil before using for the first time.

Operating the gearbox with insufficient oil will damage the gearbox.

Contaminated gearbox oil will reduce the service life of the gearbox.

Use the specified gearbox oil.



Check the safe condition of the product:

- Check whether there is any leakage.
- Check whether there are any visible defects.
- Check whether all parts of the product are firmly attached.
- Check that the safety devices are in faultless condition.

Starting the motor



DANGER
Danger of fire!

Spilled fuel can set the product on fire.
Carefully wipe up any spilled fuel up before starting.
Start the product a minimum of nine metres away from where you filled it.



CAUTION
Product damage!

The motor's durability and operating safety hinges on its run-in time. Always allow a cold motor to warm up for a few minutes, do not demand full power immediately. During the first 20 hours of operation (run-in time), do not push the motor to its performance limit.

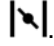
-
- Check motor oil level.
 - If the engine is with fuel pump: Set the throttle to position , Press the fuel pump (11) max. three times. If the engine is with chock: Set the throttle to position .
 - Slowly pull the pull-starter (13) straight until you feel a resistance.
 - Let the pull-starter (13) run in again.
 - Keep pulling the pull-starter (13) until the motor starts.
 - If the motor does not start, repeat the starting procedure. After starting the motor, set the required motor speed using the throttle (14).



Note:
Pull the pull-starter max. 50 cm out and let it run back in slowly by hand.

Switching off the motor



WARNING
Risk of injury!

Always switch off the product when not in use for short periods.

-
- Set the throttle (14) to position .

Mowing



WARNING
Risk of injury!

Before beginning work, check the terrain and remove all objects that may be flung out by the product.



WARNING
Risk of injury!

Never let go of the steering while working.

WARNING**Risk of injury!**

If there is a risk of slipping on slopes, the product is to be held by a second person using a bar or a rope. The second person must stand above the product and maintain an adequate distance from the cutting tool.

Always work across slopes, never upwards or downwards. Be especially vigilant when changing direction.

WARNING**Risk of injury!**

Do not clean the cutting tool while the engine is running. Switch off the motor and remove the spark plug connector. Always use aids, e.g. a piece of wood for removing jammed objects.

- Start the motor.
- Use the throttle to set the motor to the required speed.
- Press the coupling handle (1) and keep it pressed.
- Pull the coupling handle (15) and keep it pulled.
- Switch off the motor after completing the work.

Cleaning and maintenance

WARNING**Risk of injury!**

Before any maintenance or cleaning work:

- Switch off motor.
 - Allow the product to cool down.
 - Disconnect the spark plug.
-

WARNING**Risk of injury!**

Perform only the maintenance work described here yourself.

Any other work, especially motor maintenance and repairs must be performed by a trained professional. Improper work can cause product damage and hence physical injury.

Cleaning and maintenance at a glance

Before each use

What?	How?
Check screw connections are tight.	Hand-tighten the screw connections using the appropriate tool.
Check motor oil level.	Checking the motor oil level
Check tyre pressure.	Air pressure gauge.
Check cable of the pull-starter for damage.	Visual inspection.

After each use

What?	How?
Clean the product.	Cleaning the product
Lubricate the cutting tool.	Lubricate the cutting tool with a little lubricating grease.

After the first five operating hours

What?	How?
Change the motor oil.	Draining the motor oil.

Every 25 operating hours or every 3 months

What?	How?
Replace the air filter.	Cleaning/replacing the air filter
Remove grass and dirt from rotating parts.	Using a brush or another suitable blunt object.
Clean covers.	Wipe down with a slightly damp cloth.

Every 100 operating hours or every 12 months

What?	How?
Clean/replace the spark plug.	Cleaning/replacing the spark plug
Change the gearbox/motor oil.	Draining the motor oil Changing the gearbox oil

Cleaning the product



WARNING

Risk of injury!

Clean the cutting tool carefully. The cutting tool may still move even though the product is switched off.

Careful handling and regular cleaning ensure that the product remains functional and efficient for a long time.

Clean the product immediately after each use. Dried-on grass is extremely hard and difficult to remove.

- Brush off coarse dirt.
- Wipe down the product with a slightly damp cloth.
- Never spray the product with water or expose it to water.
- Never use cleaning agents or solvents.
- Keep ventilation slots clean and free of dust.

Checking the motor oil level

CAUTION

Product damage!

The product is supplied without motor oil.

Make sure it is filled with motor oil before using for the first time.

The oil level must be checked and topped up refilled each time before using the motor.

Operating the motor with insufficient oil will damage the motor.

Dirty oil or two-stroke motor oil reduces the service life of the motor.

The motor oil must be changed after the first five operating hours.

Use the specified motor oil.



- Switch off the motor.
- Disconnect the spark plug.
- Unscrew and remove the motor oil filling plug (5).

The oil dipstick is fastened to the motor oil filling plug (5).

- Wipe the dipstick clean using a cloth.
- Insert the motor oil filling plug (5) with the dipstick again and screw in.
- Unscrew the motor oil filling plug (5) again and pull it out.
- Check the oil level.

The oil level should be at the top marking (A) of the oil dipstick. If the oil level is below the bottom limit mark (B) of the oil dipstick, slowly top up with oil until the oil level reaches the top mark on the oil dipstick. Do not overfill the product.

- Check the seal in the motor oil filling plug (5) for damage and clean if necessary.

Replace a damaged seal immediately!

- Insert the motor oil filling plug(5) again and tighten it by hand.

Draining the motor oil

- Switch off the motor.
- Disconnect the spark plug.
- Unscrew and remove the motor oil filling plug (5).
- Hold a collecting container below the motor oil drain plug (35).
- Unscrew and remove the motor oil drain plug (35) using a suitable tool.
- Allow the motor oil to drain completely.
- Insert the motor oil drain plug (35) and tighten using a suitable tool.
- Top up motor oil before using again.

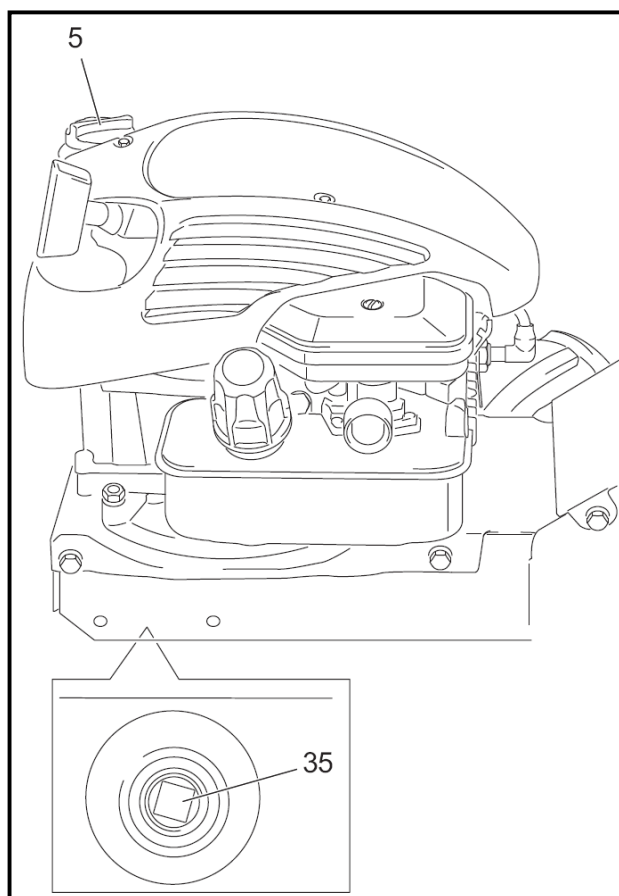
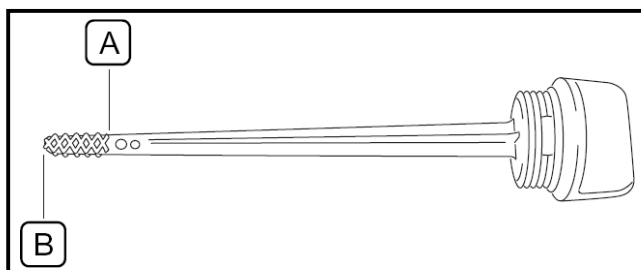

Draining the gearbox oil

- Switch off the motor.
- Disconnect the spark plug.
- Hold a collecting container below the gearbox oil drain plug (37).
- Unscrew and remove the gearbox oil filling plug (36) and gearbox oil drain plug (37) using a suitable tool.
- Allow the gearbox oil to drain completely.
- Insert the gearbox oil drain plug (37) and tighten using a suitable tool.
- Top up gearbox oil before using again.

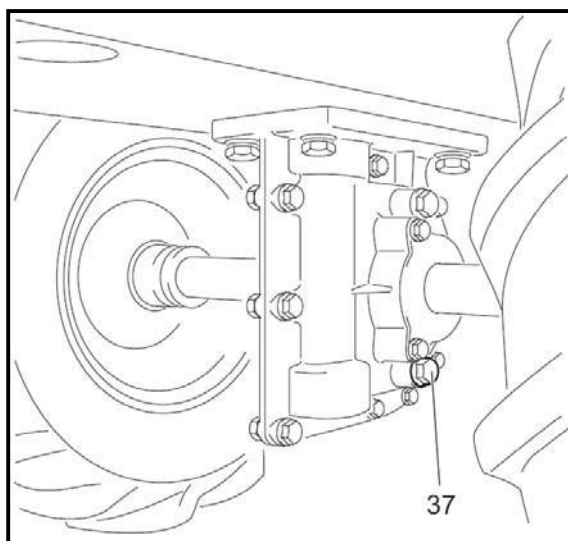

Cleaning/replacing the air filter



CAUTION
Product damage!

The product must never be operated without the air filter, as this can cause damage to the motor.
The air filter must be replaced if it is damaged or badly contaminated.

- Switch off the motor.
- Disconnect the spark plug.
- Remove the bolts and air filter cover. Be careful to prevent dirt and debris from falling into the air filter base opening.
- Remove the foam element or paper element.
- Check, clean or replace the damaged air cleaner parts.
- Reinstall the air filter parts, then bolt and screw down it.



WARNING

Never clean the air filter element with gasoline or low flash-point detergents, or explosion may happen.



CAUTION

Clean the foam filter with soapy water, blow the paper element with compressed air or lightly tap off dust and never dry to brush.

Cleaning/replacing the spark plug



CAUTION
Product damage!

To clean the spark plug, use only wire brushes with brass bristles. Bristles of any other material will damage the electrode!



CAUTION

Product damage!
Fit the spark plug only when motor is cold.

- Switch off the motor.
- Pull off the spark plug connector (40).
- Unscrew the spark plug (41).
- Check the electrode for discolouration.
Standard colour: light brown
- Check the electrode distance.
Correct distance: 0.7 mm to 0.8 mm

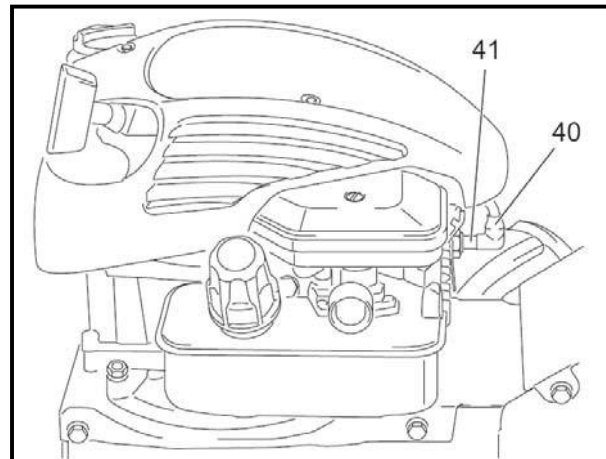

Cleaning the spark plug

- Remove rust from the electrode with a wire brush.

Replacing the spark plug

- Insert a cleaned or new spark plug and tighten by hand.
- Tighten hand-tightened spark plug by approx. quarter of a rotation using the spark plug wrench. Do not tighten spark plug too tight, otherwise the threads will be damaged.
- Replace the spark plug connector (40) firmly on the spark plug.

Changing the gearbox oil

- Draining the gearbox oil
- Filling with gearbox oil

Storage and transport



WARNING

Risk of injury!

The motor must be switched off during maintenance and cleaning work and when transporting without its own drive!

Storage

- Let the product cool before storing.
- Store the product in a dry, well-ventilated place.

Longer downtimes (3 months or longer)

Always remove fuel from the product before storing for longer periods.

- Empty the tank.
- Start the motor and let it run until the motor switches off by itself.

Transportation in a vehicle

- Allow the product to cool down.
- Empty the tank.
- Secure the product to stop it slipping and tipping over.

Disposal

Disposing of the product

**CAUTION****Environmental damage, fire hazard!**

Avoid damage caused by leaking fuel, motor oil or gearbox oil: Remove all operating media before disposing of the product.

Do not dispose of the product with the household waste! Proper disposal is mandatory. Information can be obtained from the responsible waste disposal facility.

Disposing of packaging



The packaging consists of cardboard and appropriately marked films, which can be recycled.



- Take these materials to a recycling facility.

Troubleshooting**If something isn't working...****WARNING****Risk of injury!**

Improper repairs can result in the product functioning unsafely. This endangers yourself and your environment.



Malfunctions are often caused by minor faults. You can easily remedy most of these yourself. Please consult the following table before contacting the dealer. You will save yourself a lot of trouble and possibly money too.

Fault/malfunction	Cause	Remedy
Motor does not start.	Tank empty?	Filling with fuel
	Excess fuel in the combustion chamber?	Screw out the spark plug, dry off the electrode and start with throttle fully open.
	Incorrect fuel?	Drain tank and fill up with the correct fuel. If the engine with fuel pump: Set the
	Throttle at  ?	throttle to position  . If the engine with choke: Set the throttle to position  .
	Spark plug connector not firmly attached?	Push the connector firmly onto the spark plug.
	Spark plug connector contaminated?	Clean the spark plug connector.
	Spark plug contaminated?	Clean the spark plug
	Electrode clearance of spark plug incorrect?	Adjust gap to 0.7 mm to 0.8 mm.
	Spark plug defective?	Replace spark plug
	Air filter contaminated?	Cleaning/replacing the air filter

Fault/malfunction	Cause	Remedy
Motor misfires when running.	Spark plug connector not firmly attached?	Push the connector firmly onto the spark plug.
	Air filter contaminated?	Cleaning/replacing the air filter
	Incorrect fuel?	Drain tank and fill up with the correct fuel.
	Fuel contaminated?	Empty tank and fill up with fresh fuel.
Motor does not reach the maximum speed.	Throttle at  ?	Return throttle to direction  .
	Air filter contaminated?	Cleaning/replacing the air filter
	Spark plug contaminated?	Clean the spark plug
	Distance from electrode to spark plug too great?	Adjust gap to 0.7 mm to 0.8 mm.
Drive is not working.	Incorrect fuel?	Drain tank and fill up with the correct fuel
	Wrong tension of Bowden cable for the drive?	Have it checked by an expert.
Mowing drive is not working.	Drive defective?	Have it checked by an expert.
	Wrong tension of Bowden cable for the mowing drive?	Have it checked by an expert.
Strong vibrations	Mowing drive defective?	Have it checked by an expert.
	Loose or damaged parts?	Check the product for loose or damaged parts.

If you cannot eliminate the error yourself, please contact Dealer's Service directly. Please be aware that any improper repairs will also invalidate the warranty and additional costs may be incurred.

Usable fuels and lubricants

	DANGER Danger of fire! Avoid damage caused by leaking fuel: Drain the tank before disposing of the product.
	CAUTION Environmental damage! Damage caused by leaking operating media: Remove operating media before disposing of the product.

- Normal petrol, unleaded, recommend gasoline grade 90# over.
- Motor oil: SAE 15W-40 or 10W-30
- Gearbox oil: L-CKE-/P-320